

**FOR LEASE \$18.95 GROSS**

# PARK PLACE ONE

3201 W. WHITE OAKS DRIVE

A Premier Class A Office Building in Springfield, Illinois



The Real Estate Group  
907 Clocktower Dr.  
Springfield  
IL 62704

Curtis D. Tillett  
Office: 217-726-3298  
Cell: 217-553-7022  
curtis@curtistillett.com

Lindsey Leonard  
Office: 217-726-3298  
Cell: 217-899-4888  
lindsey@curtistillett.com



# RENT: \$18.95/SF GROSS

# PARKING RATIO: 4:1000

This Class A four-story office building was constructed in 1988 and is situated on the thriving west side of Springfield. Boasting a diverse and esteemed collection of national, regional, and well-known tenants, the building offers abundant parking facilities. Encompassing 100,184 square feet of prime space, the property occupies 5.91 acres.

## BUILDING HIGHLIGHTS

- Superior Class A Office Space
- Oversized Windows Providing Abundant Natural Light Throughout Offices
- Conveniently located in the Desirable Southwest Office Market, North of the Interstate 72 and Highway 4 Exchange
- Within walking distance to a plethora of retail and dining options, civic centers, financial institutions, including Southwest Plaza Shopping Center and White Oaks Mall
- Ample Parking
- 24 Hour Access
- Versatile Office Configurations
- Distinguished and Reputable Tenant Roster





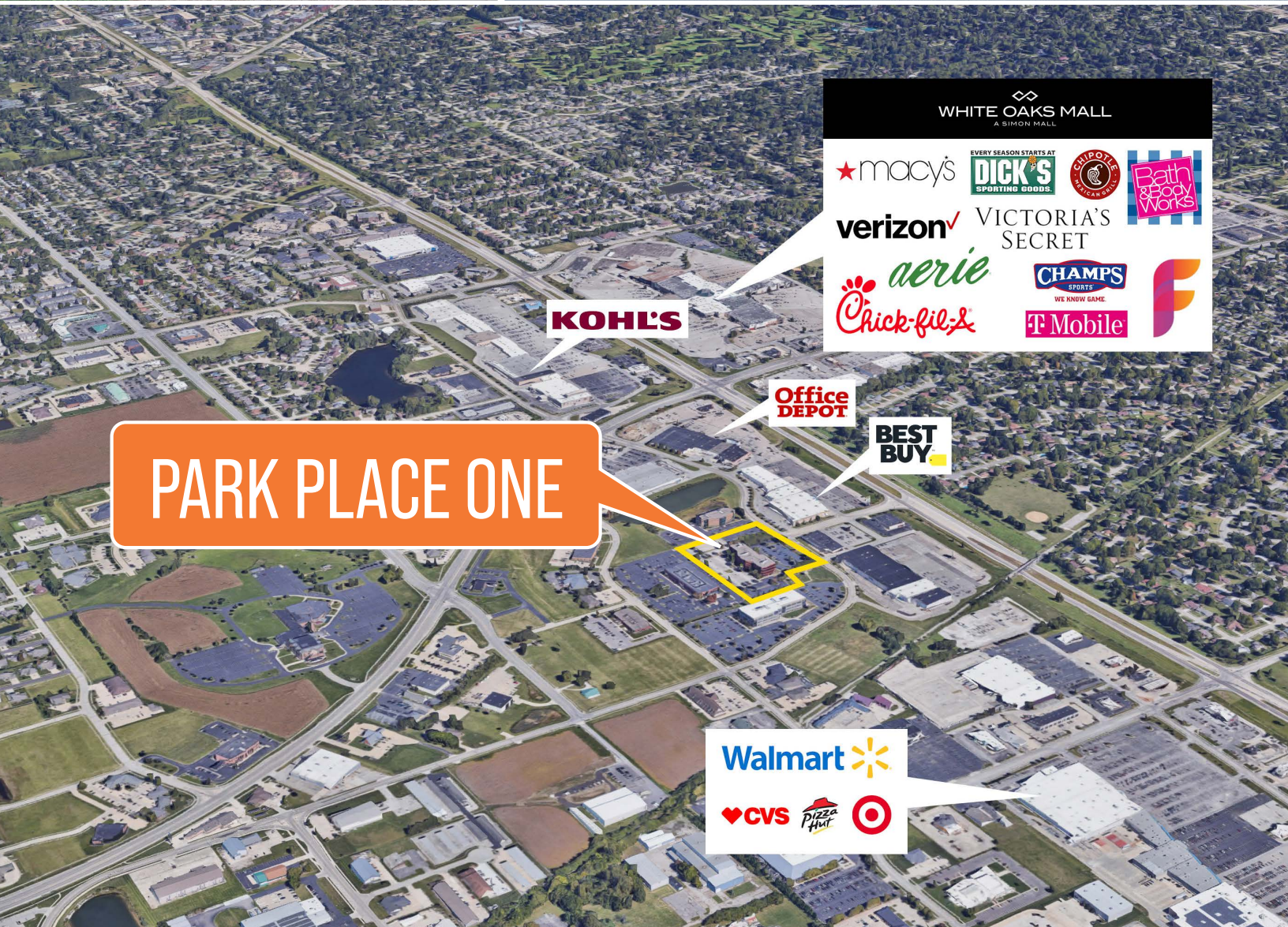



# AVAILABILITY

Suite 203: 915 sq. ft.

Suite 204: 5,064 sq. ft.

Suite 206: 1,460 sq. ft.

Suite 401: 10,761 sq. ft.

## FLOOR PLAN 2

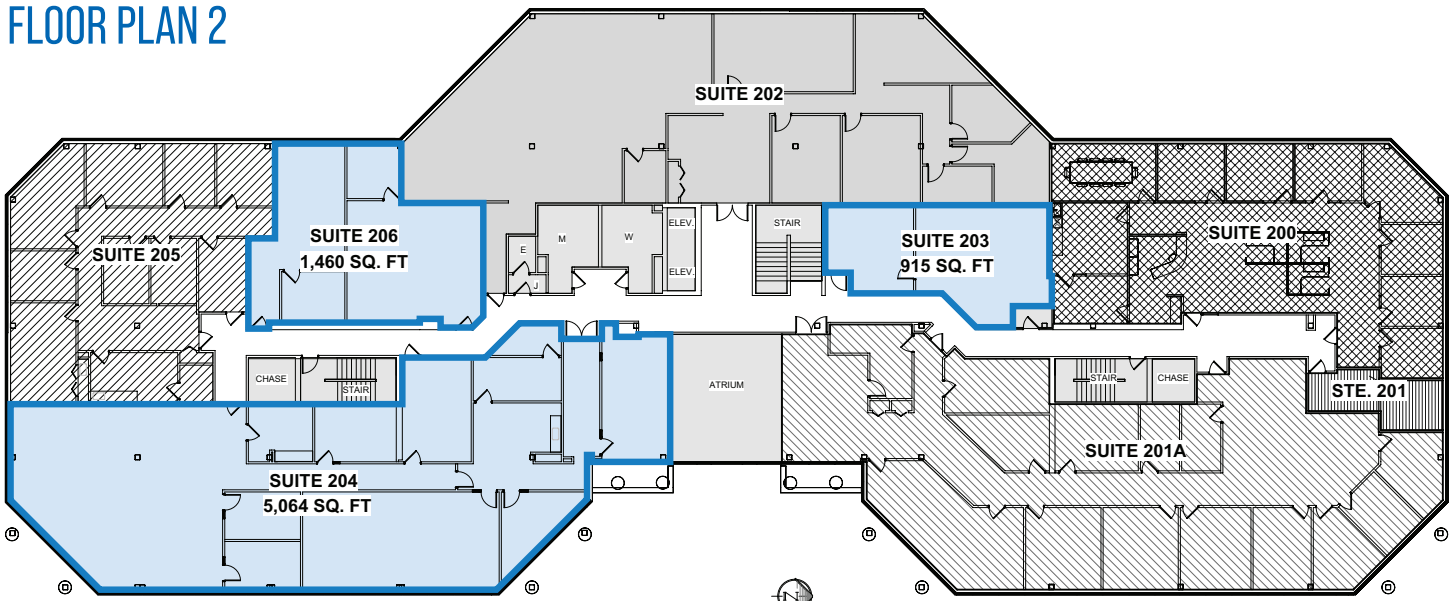

## FLOOR PLAN 4

